



An AMANO  
Company

# Aria Cash

## Pay-in-Lane/ Pay-on-Foot Station



Aria Cash Stations have the smallest footprint of any cash-handling pay-on-foot station in the industry. Aria Cash processes 2D barcode tickets, supports ticketless and credit card payment, and accepts bank notes for cash transactions. Payment options include validations, credit card, mobile payment, and bank notes. Intuitive user guidance is provided through a large, touchscreen display with built-in camera and IP intercom for call center capability.

### Features

- Banknote recycler
- 2D barcode system
- P2PE credit card options
- Bluetooth reader options
- TCP/IP network connectivity
- Optional cellular backup
- Modular USB components for easy service
- Intercom and camera for built-in call center
- LPR capability
- Textured powder coat finish
- Small footprint
- Communicates with Aria cloud-based software driven by CVPS



# Aria Cash

## Pay-in-Lane/Pay-on-Foot Station

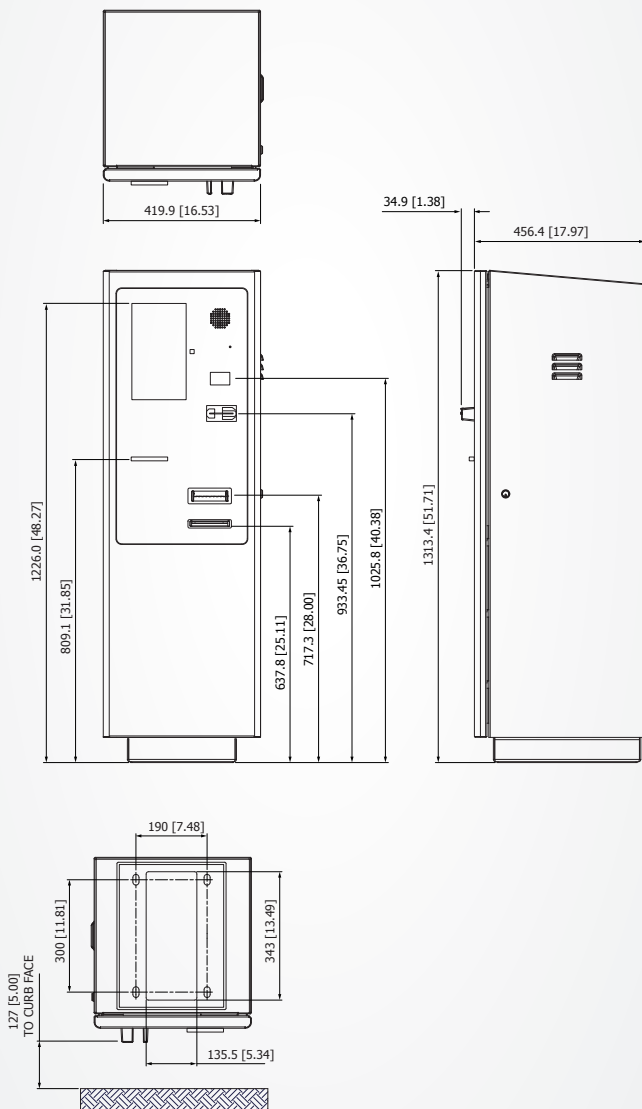

### SPECIFICATIONS

#### COMPLIANCE

RoHS Compliant

Aria Series One Entry, Exit, and Pay-on-Foot devices do not store credit card data

Pay-on-Foot Station meets ADA (Americans with Disabilities Act) requirements

#### ELECTRICAL

**Power Source:** 120 VAC, 60 Hz

**Utilization:** (120V) 6.25 amp momentary max, 4 amp idle

#### ENVIRONMENT

**Temperature:** -20°F ~ 120°F (-29°C ~ 49°C) with optional heater kit for low temperatures

**Humidity:** 10% ~ 90% (non-condensing)

#### HOUSING

Heavy-duty, 14-gauge steel construction, weather gasketing, lockable door

**Height:** 51.6" (131.1 cm)

**Width:** 16.6" (42.2 cm)

**Depth:** 19.18" (48.7 cm)

**Weight:** 210 lbs. ( 95.3kg), 276.5 lbs (125.5kg) with BNR installed

**Finish (Standard):** Textured powder coat finish Aria Grey (RAL#7047)

#### DISPLAY

**Height:** 10.0" (25.4 cm)

**Width:** 5.625" (14.3 cm)

#### BANK NOTE CAPACITIES

Recycles up to 4 denominations with a total capacity of 430 notes

Includes one cash loader cassette (250 banknote capacity)

Includes one cash box (600 banknote capacity)

#### TICKET READER/ENCODING MECHANISM

Thermal printer

Encodes 2D data matrix barcode data

Reads all accepted 2D data matrix barcode tickets and validation coupons

#### INTERCOM/CAMERA

Integrated IP intercom and camera

#### OPTIONS

Bluetooth reader optional

LPR optional



An AMANO Company